

2006

# Travel Supreme



**Limited TWO (2) Year Warranty**

*Travel Supreme offers a limited warranty on all our recreational vehicles for 24 months from date of purchase against defects in materials or faulty workmanship. It applies to the original owner only and is available upon request for inspection. Individual manufacturer warranties apply to various other components we use.*

**FIVE (5) Year Structural Warranty**

*The limited 5 year structural warranty provides a guarantee against all defects in materials or faulty workmanship for the Aluminum/Steel super-structure for 60 months from date of purchase. It applies to the original owner and is available upon request for inspection.*

**CUMMINS ENGINE 5 YEAR WARRANTY**

*All Cummins engines are warranted for 5 years or 100,000 miles.*

**SPARTAN CHASSIS 3 YEAR WARRANTY**

*All Spartan chassis are warranted for 3 years or 50,000 miles.*



Travel Supreme reserves the right to make changes in products, components, materials, and prices at any time without obligation. Some photos are shown with optional equipment. Please see Standards and Options list for complete details

*Your Nearest Dealer*

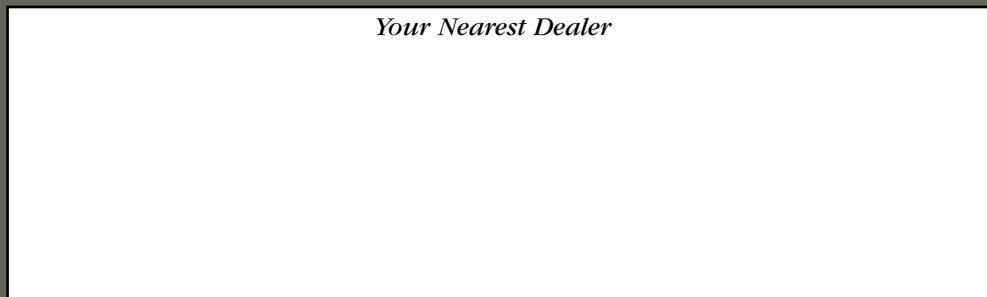

TRAVEL SUPREME, INC.,  
P.O. BOX 610,  
66149 STATE ROAD 19,  
WAKARUSA, IN 46573  
574-862-4484  
FAX 574-862-2065  
www.travelsupreme.com



**C L A S S A D I E S E L P U S H E R**



*Aged Black interior with Burnished Glazed Maple hardwood cabinets.*

*Kitchen and living/dining room slideouts add tremendous living space to all our diesel pushers. Among Travel Supreme's most appreciated amenities are outstanding storage, exceptional lighting and careful craftsmanship. Pictured here is the Aged Black interior with Burnished Glazed Maple hardwood cabinets.*



**Travel Supreme.  
Everything a Motorhome should be.**

It's difficult to believe this is a motorhome! Examine the combination of fine wood cabinetry and trim. The plush fabrics, beautifully finished flooring and window treatments that are classy without being fussy. Notice the solid surface counters, black kitchen appliances, the supple leather Euro chair with matching ottoman, and the 40" LCD HDTV & home theatre system (optional). This is Travel Supreme's 2006 diesel pusher. It's where beauty and function blend together to create exquisite style and it's what we believe a motorhome should be: fine, functional and fabulous! After all, life isn't just about where you go, it's about how you get there. Go ahead. Enjoy the journey as well as the destination. In Travel Supreme style, of course.



*Talk about Supreme comfort! Queen size beds have their own slideout, each with a window and a night stand on either side of the bed. A bedspread, headboard, pillow shams and window treatments are all beautifully coordinated.*



*Whether you choose standard oak, optional cherry, maple, burnished glazed maple, glazed spice maple or walnut wood accents, you'll appreciate the careful fit and finish that made Travel Supreme famous. Padded vinyl ceilings provide noise abatement and are easy to clean. Window treatments include wood-trimmed valances and wood side panels as well as day/night shades.*

**Travel Supreme! Need We Say More?**

Picture yourself here. If it feels like the place you want to be, you owe it to yourself to take a complete tour of these extraordinary products. The journey of a lifetime begins with a visit to your Travel Supreme dealer.



*Model 40 DSO4 with cherry hardwood and Sugar & Spice decor*



*Convenient split baths save time. Several floorplans have two lavatory sinks. A skylight and fluted shower door are standard.*

*Cherry hardwood*



*Cherry hardwood*

*Storage is terrific in this bedroom floorplan. A built-in flat-screen TV and window alcove add style and function.*



*Walnut Hardwood*

*Rich walnut hardwood is a beautiful accent for our glass-door butch. Standard are dual slideouts, a wrap-around kitchen counter, dinette chandelier, living room wall lights and lighting in virtually every needed location, including on kitchen toe kicks and at entrance doors.*

▲  
*With a Travel Supreme you'll always have a room with a view – inside and out. Satisfy your personal tastes and lifestyle with our splendid choice of hardwoods and fabrics.*



*This quiet 8KW Onan diesel generator slides out in its own tray for easy accessibility and lets you enjoy the comfort of electricity almost anywhere.*



*Maintenance is fast and easy with this exterior service area. Includes a water tank fill, tank drain, a wash down sprayer and a hose with optional automatic rewind function.*



*Remarkably functional kitchens offer every necessity and a lot more. Check out the storage, lighting and easy-care solid surface counters. The dining table is just a few steps away to reduce meal serving and clean-up time.*



*Oak hardwood*



*An optional electric fireplace adds a beautiful touch of class to your Travel Supreme home.*



*Superbly equipped kitchens feature virtually everything: a double door refrigerator, uncommonly generous storage, a microwave, black glass oven and a Corian range cover and counters. At left is a living area work station (some models) that's perfect for crafting or computer time.*



*Massive storage compartments feature optional slide-out trays to make loading and unloading a snap.*



## Check Out Our 42' Tag Axle Design...

*Drive easy in this futuristic, functional cockpit. The backlit Smart Wheel telescopes and tilts for increased driver comfort and has a handy touchpad with controls for cruise, wipers, washers, and brights. An in-dash color monitor shows you what the backup camera sees. Additional controls for temperature, defrost and sound systems are nearby. At Travel Supreme, we know that when it comes to safe driving, one size does not fit all. That's why we offer fully adjustable power foot pedals, too.*



*Enjoy a complete view of every place your travels lead with our extra large wrap-around windshield and side door windows. The great view enhances your safety, too.*

*This 2006 42' Travel Supreme tag axle quad slideout model provides even more of what you expect in a luxury RV. In a class by itself, this motorhome has a 400 ISL Cummins engine, Allison 6 speed transmission, independent front suspension (IFS), huge cargo carrying capacity and Travel Supreme's trademark outside storage compartments. Most manufacturers only claim to give you the best value for your motorhome dollar; Travel Supreme delivers. Compare our features to the others and you'll find out we have exactly what you want!*

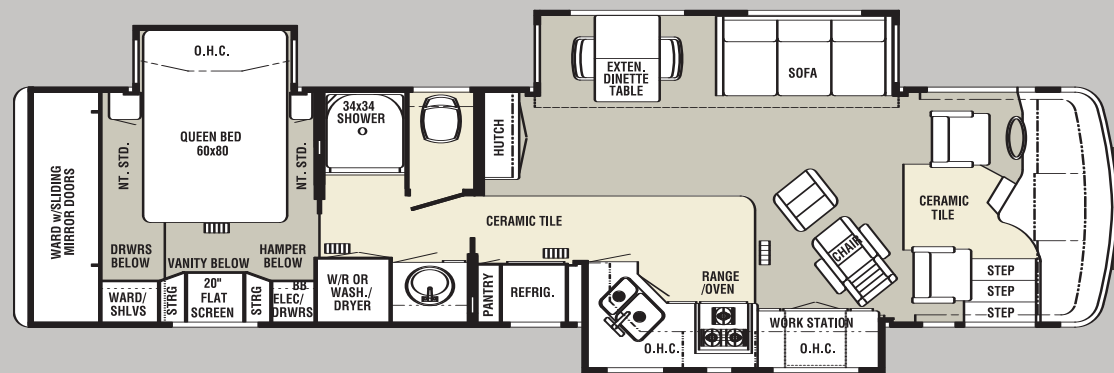

**38DS03**  
Available  
w/Options B,G

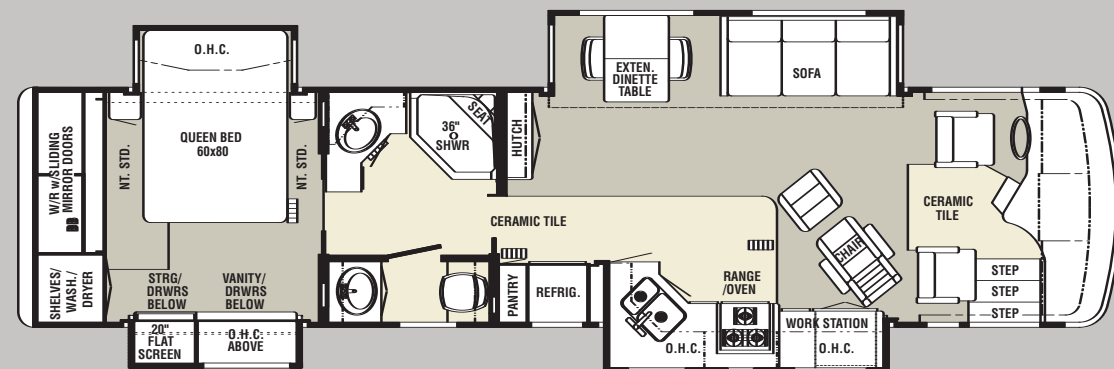

**38DS04**  
Available  
w/Option C

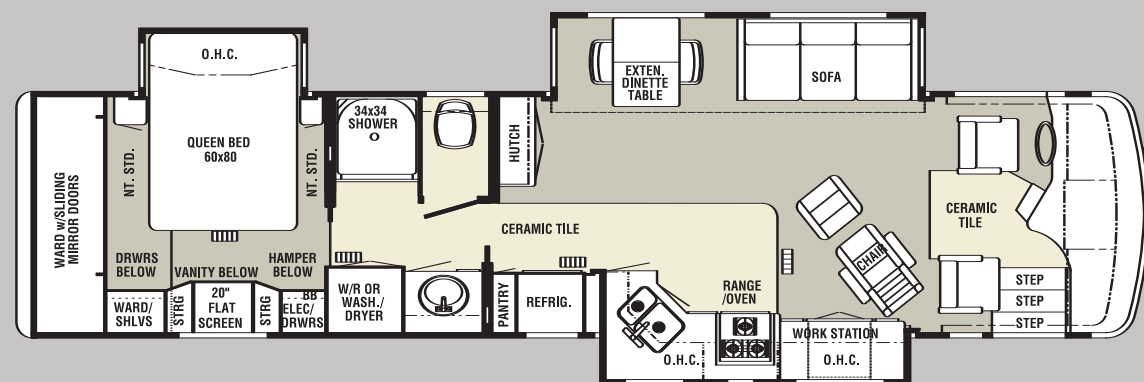

**40DS03**  
Available  
w/Options D,E,F,G

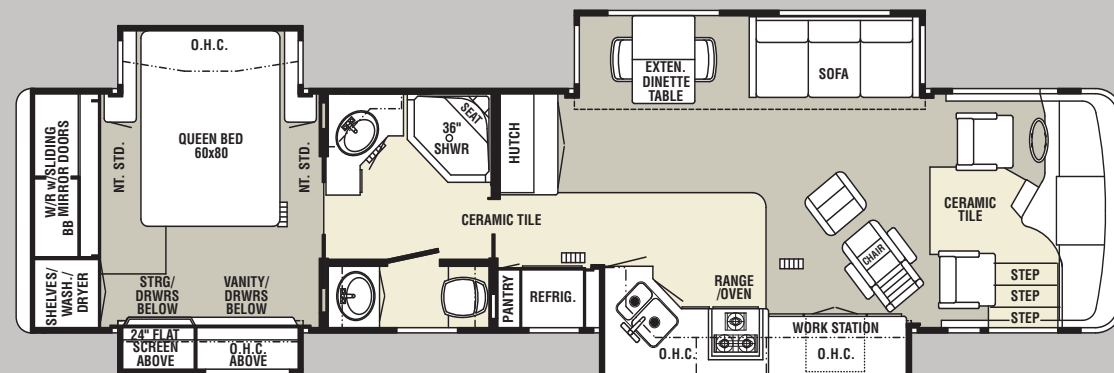

**40DS04**  
Available  
w/Options D,E,F,G

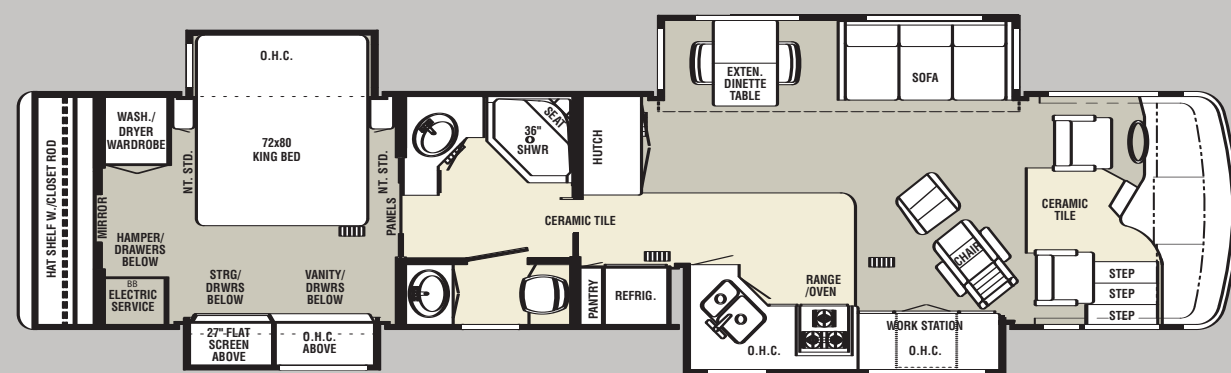

**42DS04**  
Available  
w/Options D,E,F,G

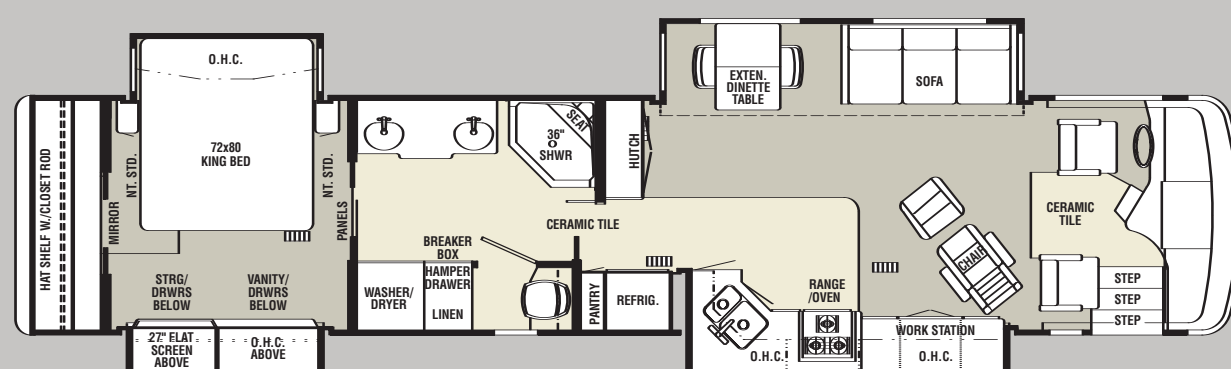

**42DL14**  
Available  
w/Option F,G

 **Carpeting**  **Ceramic Tile**

**Option A**

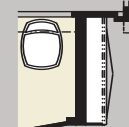

Opt. Entertainment Center  
W/40" LCD HDTV

**Option B**



Opt. Entertainment Center  
W/40" LCD HDTV

**Option C**

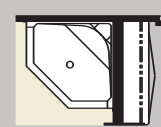

Opt. Entertainment Center  
W/40" LCD HDTV

**Option D**

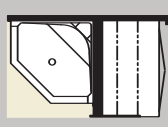

Opt. Entertainment Center  
W/40" LCD HDTV

**Option E**

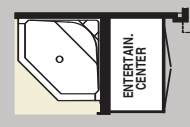

Opt. Entertainment Center  
W/40" LCD HDTV



**Option F**



**Option G**



**SPARTAN ONE STOP CUSTOMER CARE PROGRAM "Roadside Assistance Program"**

- 24hr. 7 day-a-week phone assistance • Towing assistance/coverage • Flat tire assistance/coverage • Fuel delivery
- Lock-out protection



*All models are built on dependable Spartan chassis, one of the finest available.*

## STANDARD FEATURES

### Chassis & Automotive Features

Spartan Chassis-Mountainmaster  
 Raised Rail For Maximum Storage  
 Cummins ISL 400 Engine on 38', 40' and 42' (All ISL Engines Standard with Hi-Lo Engine Jake Brakes)  
 Allison 3000 MH Electronic 6 - Speed 12,600 Independent front Suspension w/57° turn on 38' Models  
 14,600 Independent front Suspension w/55° turn on 40' & 42'  
 Air Suspension  
 Anti-Lock Air Brakes  
 Bilstein Shocks  
 VIP Smart Steering Wheel w/Touch Pad, Tilt & Telescope(38', 40', 42')  
 Chrome Dash Gauges w/Back Lighting  
 Cruise Control  
 Intermittent Wipers  
 Adjustable Foot Pedals  
 High Output Dash Heater & AC  
 Full Body Paint w/3M Front Mask  
 Exterior Heated Mirror w/Remote  
 Fuel Fills On Both Sides  
 Radial Tires  
 Aluminum Wheels  
 Towing Hitch w/Wiring (Class IV 10,000 GVWR)  
 Auto- Hydraulic Levelers w/Touch Control  
 Driving Lamps

Spartan Chassis Warranty  
 3 Years - 50,000 No Deductible  
 Spartan Motors Twenty Four Hour One-Stop Customer Care Road Side Assistance Program

### Electrical & Heating

Two (2) 13.5 BTU Penguin Central AC  
 42,000 BTU Furnace  
 Two (2) 6 Volt Deep Cycle Batteries  
 Onan 8 KW Quiet Diesel Generator On Slide Tray  
 Auto Generator Changeover  
 50 AMP Service  
 Battery Disconnect Switch  
 Progressive Dynamic Convertor (80 AMP)  
 Video Selector Box w/Home Theatre System (Winegard VS-0604)  
 Winterizing Kit  
 2nd Water pump Switch At Dump Station  
 5-Watt Solar Panel To Chassis Batteries  
 Water Heater-10 Gallon w/DSI Gas & Electric  
 CO Detector  
 LP Leak Detector  
 Smoke Detector & Fire Extinguisher

### Appliances/Accessories

3 Burner Range & Oven w/Corian Cover  
 Dometic 3862 Refrigerator  
 30" Spacesaver Microwave  
 24" Flatscreen TV (Dash Overhead)  
 Flatscreen TV (Rear Bedroom)  
 VCR/DVD Combo  
 AM/FM Stereo W/Dash CD  
 Color Rear View Monitor System  
 TV Antenna w/Power Booster  
 Dual Pane Windows  
 Telephone Prep  
 Cable Prep  
 Satellite Prep  
 Brushed Chrome Lav accessories  
 Fluted Shower Door w/Towel Bar  
 Monitor System  
 Skylight In Bath  
 Fantastic Fan In Bath  
 Side Awning (A&E or Carefree)  
 Detachable Rear Ladder

### Interior Appointments

7' Ceiling Height  
 Padded Vinyl Ceiling  
 Oak Hardwood Cabinets  
 Corian Countertop In Kit & Bath  
 Ceramic Tile Foyer  
 Ceramic Tile (Kit & Bath)  
 Ceramic Backsplash w/Marble Inlay In Kitchen

Day/Night Shades  
 Wood Shadowbox Valances W/Fabric Accents  
 Sleeper Sofa  
 6-Way Power Seats (Power Foot Rest Passenger Side)  
 Flexsteel Leather Chairs (Driver & Passenger)  
 Flexsteel Leather Euro Chairs w/Freestanding Ottoman  
 Courtesy Lights At Toe Kicks  
 Dinette Lighting  
 Living Room Wall Lights  
 Lights At Entrance Steps  
 Queen-Sized Bed (38' & 40' Models)  
 King -Sized Bed (42' Models)  
 Bedspread, Bedskirt, & Pillow Shams  
 Cedar Closet  
 Double Pocket Doors In Some Models

### Construction Specs

Aluminum Sidewalls (16" Center)  
 1/2" Foam Insulation R3 Laminated To Sidewall  
 Fiberglass Insulation: Sidewalls (R10), Roof (R19), Floor (R19)  
 Aluminum Superstructure  
 Gelcoat Fiberglass Exterior  
 Vinyl Roof w/3/8 Plywood Decking  
 New Front Cap w/120MM Low Beam and 120 MM High Beam Headlights

## POPULAR OPTIONAL FEATURES

13.5 Penguin Heat Pumps ILO Std  
 15,000 Penguin Heat Pumps ILO Std  
 Microwave Spacesaver Convection (GE) ILO Std  
 Dometic 1062 New Dimension Refer ILO Std  
 Omit Oven and Add Doors and Shelves  
 Side-By-Side Ref. (Norcold Or Dometic)  
 Ice Maker In Refer  
 Exterior Freezer w/Slide Tray  
 Compact Washer & Dryer (1 or 2 Piece)  
 Fiberglass Roof  
 One Touch Power Awning A&E Or Carefree  
 Window Awning 9000 A&E or Carefree

Slide Topper 9000 A&E Or Carefree  
 Entry Door Awning  
 Sidevisors Maxi-Carefree  
 Power Front Visors  
 Keyless Entry System w/Remote  
 Power Locks for Storage Compartment Doors  
 CB Antenna & Radio  
 Docking Lights  
 Weldex Side Cameras  
 Slide-Out Cargo Tray  
 Raised Panel Mirror w/Pocket Door  
 Ceiling Mirror Feature(Living Room)  
 Maple, Burnished Glazed Maple, Glazed Spice Maple, Walnut or Cherry Wood Cabinetry  
 6-Way Buddy Seat w/Power Foot Rest

Leather Sofa ILO Std  
 Ultra Leather ILO Std Leather  
 Dinette Folding Chairs  
 Chrome Mirrors ILO Std  
 10 Disc CD Changer (For Dash Stereo)  
 Electric Fireplace  
 Home Theatre System w/32" Flat Screen TV  
 40" LCD HDTV w/Home Theatre System  
 Pioneer Navigation(1 Disc DVD Rom)  
 Ceiling Mirror Feature(Bedroom)  
 King Size Bed (Optional in 40' Models)  
 XM Radio Tuner/Antenna  
 Kingdome & Trac Vision Satellite Dish  
 Air Horns  
 Mudflaps w/Stainless Steel Logo  
 50 Amp Power Cord Rewind (12 volt)

2000 Watt Invertor (2) 6-Volt Batt.  
 In-Dash Compass & Exterior Temperature  
 Outside AM/FM/CD Stereo System  
 Roof Spot Light-Remote Control  
 Auto Rewind Water Hose 12 Volt  
 Exterior Security Lights  
 Xenon Low Beam Headlamps  
 Water Purifier w/Faucet  
 Central Vac System  
 Hydro Hot Heating System  
 Driver Information Center  
 Dinette Table/Desk Options  
 Slide Out Corian Dinette Table



**All Cummins Engines come with a 5 year 100,000 mile warranty.**

*Cummins diesel engines deliver top performance on all Travel Supreme motorhomes. All models come with a 400 ISL engine.*

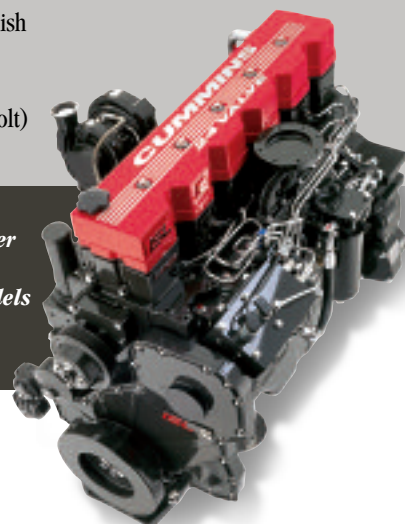

## CHASSIS & ENGINE SPECIFICATIONS

MODELS	SPARTAN CHASSIS	CUMMINS ENGINE HP	ALLISON TRANSMISSION	AXLE RATIO	FUEL GALLONS	WHEEL BASE	FRONT GAWR	REAR GAWR	GVWR	GCWR
38DS03	Mt. Master	400	Electronic 6 Speed	4.88	100	252	12,600	20,000	32,600	42,600
38DS04	Mt. Master	400	Electronic 6 Speed	4.88	100	252	12,600	20,000	32,600	42,600
40DS03	Mt. Master	400	Electronic 6 Speed	4.88	150	276	14,600	20,000	34,600	44,600
40DS04	Mt. Master	400	Electronic 6 Speed	4.88	150	276	14,600	20,000	34,600	44,600
42DS04	Mt. Master	400	Electronic 6 Speed	4.88	150	276	14,600	20,000	44,600	54,600
42DL14	Mt. Master	400	Electronic 6 Speed	4.88	150	276	14,600	20,000	44,600	54,600

NOTE: 42DS04 TAG GVWR is 10,000

## SIZES & CAPACITIES

MODELS	LENGTH	WIDTH	HEIGHT	INTERIOR WIDTH	INTERIOR HEIGHT	WATER TANK GAL.	WATER HEATER GAL.	SEWAGE TANK GAL.	GREY WATER GAL.	LP TANK GAL.
38DS03	38'8"	101"	12'6"	96"	7'	100	10	60	60	40
38DS04	38'8"	101"	12'6"	96"	7'	100	10	60	60	40
40DS03	40'5"	101"	12'6"	96"	7'	100	10	60	60	40
40DS04	40'5"	101"	12'6"	96"	7'	100	10	60	60	40
42DS04	42'5"	101"	12'6"	96"	7'	100	10	60	60	40
42DL14	42'5"	101"	12'6"	96"	7'	100	10	60	60	40

## EXTERIOR GRAPHICS & COLORS



Sahara Sand



Champagne Gold



Riviera Gold



Cashmere Beige

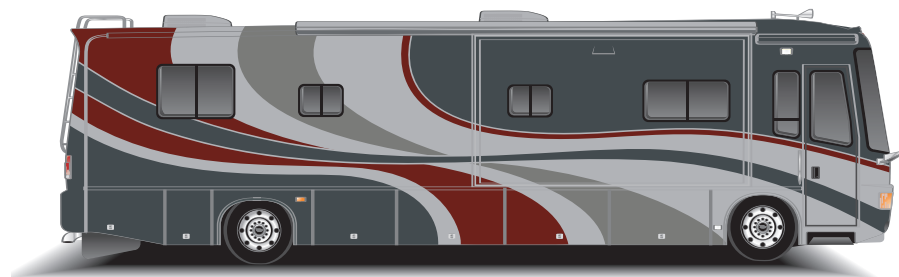

Silver Mist