

FOREST RIVER  
**SALEM**  
HEMISPHERE  
TRAVEL TRAILERS AND FIFTH WHEELS



# SALEM HEMISPHERE HL



## HYPER LYTE TRAVEL TRAILERS

For a more comprehensive look at our floorplans and 360 degree tours, please visit [www.forestriverinc.com/salem](http://www.forestriverinc.com/salem)

### VIP PACKAGE FEATURES

- XL Max-tint Panoramic Windows in Main Slide
- 12V Heat Pads on all Holding Tanks
- High-rise Faucet with Pull-out Sprayer
- Recessed Glass Stove Top Cover
- Midnight Glass Range Hood
- Midnight Glass Microwave
- Back-up Camera and Roof Mounted Solar Panel Prep
- Designer's Choice Luxury Comforter
- 32" LED TV with Bluetooth CD/DVD/FM/USB Player and Bar Speakers
- Friction Door Hinge
- Porcelain Toilet
- Baggage door magnets and easy pull slam latches
- LED Awning, Marker & Tail Lights
- Step-Above Aluminum Entry Steps (Main Entry Door)
- Power Tongue Jack with LED Docking Light



### 17RBHL

Weight: 4,903 lbs  
Length: 23' 5"



### 19RBHL

Weight: 4,788 lbs  
Length: 23' 10"

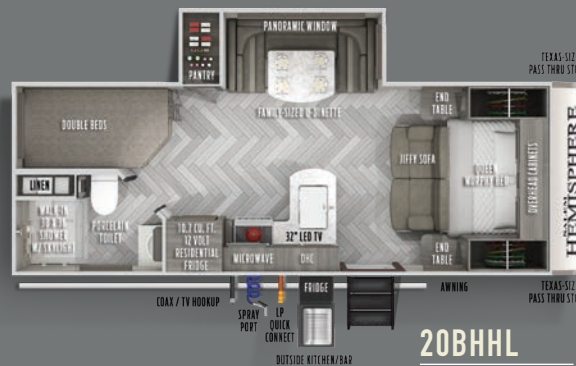

### 20BHHL

Weight: 5,593 lbs  
Length: 26'



\*For full table of specifications, see page 10



### 22RBHL

Weight: 5,413 lbs  
Length: 27' 11"



### 25RBHL

Weight: 6,038 lbs  
Length: 31'



### 23BHHL

Weight: 6,063 lbs  
Length: 30'



### 26BHHL

Weight: 6,688 lbs  
Length: 33' 9"



### 24RLHL

Weight: 5,883 lbs  
Length: 30' 2"



### 29XBHL

Weight: 7,173 lbs  
Length: 36' 10"

# SALEM HEMISPHERE

## TRAVEL TRAILERS



For a more comprehensive look at our floorplans and 360 degree tours, please visit [www.forestriverinc.com/salem](http://www.forestriverinc.com/salem)



### 270FKS

Weight: 7,818 lbs  
Length: 33' 9"



### 283RK

Weight: 7,023 lbs  
Length: 34' 8"



### 314BUD

Weight: 8,583 lbs  
Length: 39' 3"





\*For full table of specifications, see page 10

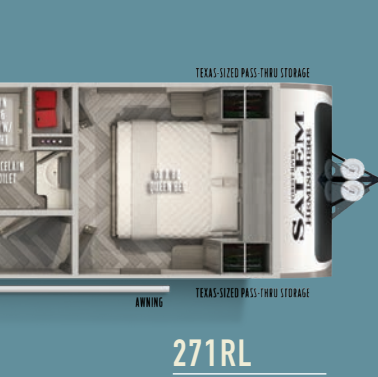

### 271RL

Weight: 7,738 lbs  
Length: 34' 7"



### 273RL

Weight: 7,893 lbs  
Length: 34' 7"



### 308RL

Weight: 9,063 lbs  
Length: 38' 7"



### 310BH1

Weight: 9,088 lbs  
Length: 38' 8"

## VIP PACKAGE FEATURES

- XL Max-tint Panoramic Window Package in Main Slide
- 12V Heat Pads on all Holding Tanks
- Recessed Glass Stove Top Cover
- Midnight Glass Range Hood
- Midnight Glass Microwave
- Porcelain Toilet
- 50" LED TV with Bluetooth CD/DVD/FM/USB Player & Bar Speakers
- Stainless Steel Single Bowl Under-mount Sink with Roll-up Sink Cover
- Friction Door Hinge
- Power Stabilizer and Tongue Jacks
- 32" Glass Front Electric Fireplace
- Baggage Door Magnets and Easy Pull Slam Latches
- Step Above Aluminum Entry Steps (Main Entry Door)
- LED Awning, Front Cap, Marker and Tail Lights
- Back-up Camera and Roof Mounted Solar Panel prep

# SALEM HEMISPHERE

## FIFTH WHEELS



For a more comprehensive look at our floorplans and 360 degree tours, please visit [www.forestriverinc.com/salem](http://www.forestriverinc.com/salem)



### 286RL

Weight: 9,229 lbs  
Length: 33' 11"



### 290RL

Weight: 9,919 lbs  
Length: 34' 11"



### 353BED

Weight: 12,634 lbs  
Length: 43' 4"

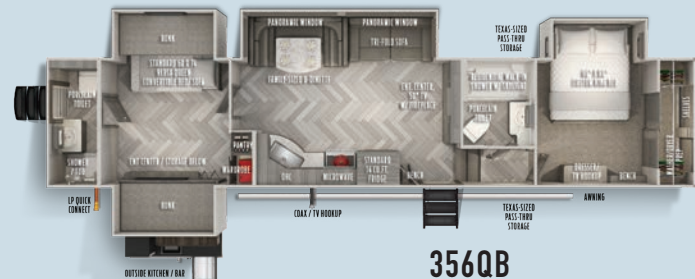

### 356QB

Weight: 11,249 lbs  
Length: 43'

## VIP PACKAGE FEATURES

- XL Max-tint Panoramic Window Package in Main Slide
- 12V Heat Pads on all Holding Tanks
- Recessed Glass Stove Top Cover
- Midnight Glass Range Hood
- Midnight Glass Microwave
- Back-up Camera and Roof Mounted Solar Panel Prep
- Power Stabilizer Jacks and Landing Gear
- 50" LED TV with Bluetooth CD/DVD/FM/USB Player & Bar Speakers (40" TV 295BH)
- Step Above Aluminum Entry Steps (Main Entry Door)
- Baggage Door Magnets and Easy Pull Slam Latches
- LED Awning, Front Cap, Marker and Tail Lights
- Friction Door Hinge
- Stainless Steel, Single Bowl Undermount Sink with Roll-up Sink Cover
- Porcelain Toilet
- 32" Glass Front Electric Fireplace



\*For full table of specifications, see page 10



### 295BH

Weight: 9,334 lbs  
Length: 36'

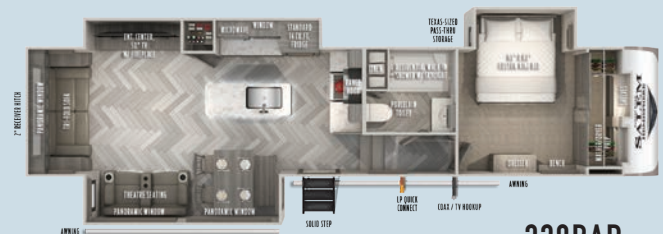

### 338BAR

Weight: 10,529 lbs  
Length: 39' 9"



### 369BL

Weight: 11,669 lbs  
Length: 43'



### 370BL

Weight: 11,524 lbs  
Length: 42' 7"



### 372RD

Weight: 11,149 lbs  
Length: 42' 9"



### 378FL

Weight: 11,589 lbs  
Length: 43' 6"

# SALEM HEMISPHERE ELITE SERIES

## FIFTH WHEEL ELITE SERIES



For a more comprehensive look at our floorplans and 360 degree tours, please visit [www.forestriverinc.com/salem](http://www.forestriverinc.com/salem)

\*For full table of specifications, see page 10



### 34RL

Weight: 11,009 lbs  
Length: 40' 6"



### 36FL

Weight: 12,624 lbs  
Length: 43' 9"

## VIP PACKAGE FEATURES

- Power Mini-max Fan in Kitchen
- Luxurious Solid Surface Kitchen Countertops
- Designer's Choice Bedding Package and Headboard
- 1.7 cu. ft. Over-the-range 30" Residential Microwave
- Panoramic Tinted Safety Glass Windows Throughout
- Residential Gas Cooktop with Built in Oven and LED Lit Knobs
- King Wifi Router/Range Extender
- 72" x 80" Residential King Mattress
- "Kick 'Em Up" Ottoman with Huge Storage in Living Room
- 12V Heat Pads on all Holding Tanks
- 32" Entry Door with Strut-Assist Easy Lift Entry Steps
- Porcelain Toilet





## FEATURING AN EXTERIOR KITCHEN

- Pull-Out Metal Bar with Stainless Steel Plumbed Sink
- Gas Griddle
- Oversized Mini Fridge
- 32" LED TV
- Ice Maker
- Off Door Side Pull Out Metal Storage Tray



# STANDARDS + OPTIONS

INTERIOR FEATURES	HL	TT	5W	ELITE
MATTE BLACK CABINET HARDWARE	S	S	S	S
STACKABLE WASHER/DRYER PREP	-	Select Models	S	S
HERRINGBONE DESIGNER'S CHOICE CONGOLEUM FLOORING	S	S	S	S
HUDSON WOOD AGREEABLE GRAIN CABINETS	S	S	S	S
PORCELAIN TOILET	S	S	S	S
RESIDENTIAL SINGLE BOWL UNDERMOUNT SINK	S	S	S	S
HIDDEN HINGES ON CABINET DOORS	S	S	S	S
10.7 CU. FT. REFRIGERATOR (12V)	S	S	-	-
8 CU. FT. GAS/ELECTRIC REFRIGERATOR	0	0	-	-
14 CU. FT. FRENCH DOOR REFRIGERATOR W/ INVERTER	-	-	S	-
13 CU. FT. GAS/ELECTRIC FRENCH DOOR REFRIGERATOR	-	-	0	0
20 CU. FT. FRENCH DOOR REFRIGERATOR	-	-	-	S
INTERIOR GRAB HANDLE AT ENTRY DOOR	S	S	S	S
YACHT TRIM CEILING FINISHES	S	S	S	S
FULL LENGTH CATHEDRAL CEILINGS	-	S	S	S

EXTERIOR FEATURES	HL	TT	5W	ELITE
TEXAS-SIZED PASS-THRU STORAGE	S	S	S	S
FULL WALK-ON ROOF W/PVC ROOF MEMBRANE	S	S	S	S
HIGH DEFINITION GRAPHICS PACKAGE	S	S	S	S
LED MARKER LIGHTS	S	S	S	S
LP QUICK CONNECT	S	S	S	S
XL LEND-A-HAND ENTRY GRAB HANDLE	S	S	S	S
WIDE STANCE AXLE SYSTEM	S	S	-	-
30" WIDE MAIN ENTRY DOOR	S	S	S	32"
7-WAY "RAIN DEFENSE" PLUG HOLDER (FRONT FRAME)	S	S	S	S
HIGH EFFICIENCY AC COOLING SYSTEM	S	S	S	S
UPGRADED INSULATION PACKAGE	S	S	S	S
VACUUM BONDED "ALUMA FRAME" SIDEWALLS AND FLOOR	S	S	S	S
HEATED AND ENCLOSED DUMP VALVES AND UNDERBELLY	S	S	S	S
ACCESSIBLY REMOVABLE UNDERBELLY PANELS	Most Models	S	S	S
RADIAL TIRES W/ BLACK-ACCENTED ALUMINUM RIMS	S	S	S	S
SHADED PET TETHER / SECURITY HOOK	S	S	S	S
TV BRACKET W/ CABLE AND 12V OUTLET	S	S	S	S
2" RECEIVER HITCH FOR STORAGE RACKS (N/A 356QB, 378FL, 36FL)	-	-	S	S

## HEMISPHERE HYPER-LYTE UPGRADED OPTIONS PACKAGE

- Tri-fold Sleeper Sofa or Theater Sofa (20BHHL, 23BHHL: Jiffy Sofa w/ Oversized U-Shaped Dinette)
- Black-accented Upgraded Aluminum Wheels
- Spare Tire and Carrier
- Outside Shower
- Ivory Performance Colored Exterior Fiberglass with Smoked Quartz Metallic Accents
- Central Switch Center

## HEMISPHERE TRAVEL TRAILER UPGRADED OPTIONS PACKAGE

- High-rise Faucet with Pull-out Sprayer
- Spare Tire and Carrier
- Outside Shower
- 15,000 A/C Ducted with Quick Cool
- Ivory Performance Colored Exterior Fiberglass with Smoked Quartz Metallic Accents
- Central Switch Center

	Exterior Length	Exterior Width	Exterior Height	Hitch Weight	UVW	CCC	Fresh Water Gallons	Black Water Gallons	Grey Water Gallons	Awning Length	Tire Size
<b>HYPER LYNES</b>											
17RBHL	23' 5"	96"	10' 10"	545	4,903	2,642	49	30	30	18'	15"
19RBHL	23' 10"	96"	10' 10"	520	4,788	2,732	49	32	62	18'	15"
20BHHL	26'	96"	10' 10"	780	5,593	2,187	49	32	62	18'	15"
22RBHL	27' 11"	96"	10' 10"	570	5,413	2,157	49	32	62	18'	15"
23BHHL	30'	96"	10' 10"	725	6,063	1,537	49	30	60	21'	15"
24RLHL	30' 2"	96"	10' 10"	810	5,883	1,927	48	32	64	16'	15"
25RBHL	31'	96"	10' 10"	640	6,038	1,602	49	32	62	18'	15"
26BHHL	33' 9"	96"	10' 10"	890	6,688	3,002	49	30	60	16'	15"
29XBHL	36' 10"	96"	10' 10"	965	7,173	2,592	49	30	60	18'	15"

<b>TRAVEL TRAILERS</b>											
270FKS	33' 9"	96"	11' 2"	1,125	7,818	2,107	57	30	90	14'	15"
271RL	34' 7"	96"	11' 2"	1,070	7,738	2,132	57	30	48	10' & 12'	15"
273RL	34' 7"	96"	11' 2"	1,055	7,893	1,962	57	30	66	20'	15"
283RK	34' 8"	96"	11' 2"	720	7,023	2,497	57	30	60	21'	15"
308RL	38' 7"	96"	11' 2"	1,225	9,063	2,362	57	30	90	10' & 12'	15"
310BHI	38' 8"	96"	11' 2"	1,200	9,088	2,312	57	30	66	10' & 12'	15"
314BUD	39' 3"	96"	11' 2"	1,150	8,583	1,527	57	60	78	18'	15"

<b>FIFTH WHEELS</b>											
286RL	33' 11"	96"	12' 7"	1,870	9,229	1,601	57	32	60	13'	15"
290RL	34' 11"	96"	12' 7"	1,825	9,919	2,106	57	30	62	11' 6" & 15'	16"
295BH	36'	96"	12' 7"	1,985	9,334	2,851	57	30	60	20'	16"
338BAR	39' 9"	96"	13' 2"	1,900	10,529	1,571	57	30	62	11' 6" & 13'	16"
356QB	43'	96"	13' 2"	1,790	11,249	2,541	57	60	90	21'	16"
353BED	43' 4"	96"	13' 4"	2,115	12,634	3,481	57	60	65	13' & 20'	16"
369BL	43'	96"	13' 1"	2,150	11,669	2,481	57	30	62	11' 6" & 17'	16"
370BL	42' 7"	96"	13' 1"	2,275	11,524	2,751	57	30	62	16'	16"
372RD	42' 9"	96"	13' 3"	2,125	11,149	2,976	57	30	62	20'	16"
378FL	43' 6"	96"	13' 6"	2,140	11,589	2,551	57	30	62	20'	16"

<b>ELITE FIFTH WHEELS</b>											
34RL	40' 6"	96"	13' 2"	2,070	11,009	3,061	57	52	101	11' 6" & 15'	16"
36FL	43' 9"	96"	13' 6"	2,120	12,624	2,876	57	70	104	20'	16"

## HEMISPHERE FIFTH WHEEL UPGRADED OPTIONS PACKAGE

- High-rise Faucet with Pull-out Sprayer
- Spare Tire and Carrier
- Ceiling Paddle Fan with Light and Wall Switch
- 15,000 A/C Ducted with Quick Cool
- Washer/Dryer Prep with 50 AMP Service and Wire/Brace for 2nd A/C
- Exterior Ladder
- Ivory Performance Colored Exterior Fiberglass with Smoked Quartz Metallic Accents
- 10 Gal. Gas/Electric DSI Water Heater
- Central Switch Center

## HEMISPHERE ELITE FIFTH WHEEL UPGRADED OPTIONS PACKAGE

- High-rise Faucet with Pull-out Sprayer
- Spare Tire and Carrier
- Exterior Ladder
- Ceiling Paddle Fan with Light and Wall Switch
- 15,000 A/C Ducted with Quick Cool
- Washer/Dryer Prep with 50 AMP Service and Wire/Brace for 2nd A/C
- Ivory Performance Colored Exterior Fiberglass with Smoked Quartz Metallic Accent
- 10 Gal. Gas/Electric DSI Water Heater
- Central Switch Center



### PRE-DELIVERY INSPECTION FACILITY

20,000 square feet of quality assurance. The bare essentials for a premium product. This state-of-the-art facility gives immediate daily feedback to production for quality assurance in every unit built.



www.ForestRiverBuyLocal.com

**24/7 EMERGENCY  
ROADSIDE ASSISTANCE  
WITH VEHICLE PURCHASE\***

<p>TOWING JUMP-STARTS TIRE CHANGES FLUID DELIVERY LOCKOUT SERVICE</p>	<p>WINCH-OUT MOBILE MECHANIC TECHNICAL SUPPORT DEALER LOCATOR SERVICES</p>
---	--



\*VALID FOR 1 YEAR FROM DATE OF PURCHASE

**FREE MEMBERSHIP**

to Forest River Owners' Group



www.forestriverfrog.com

**GVWR (Gross Vehicle Weight Rating)** - is the maximum permissible weight of the unit when fully loaded. It includes all weights, inclusive of all fluids, cargo, optional equipment and accessories. For safety and product performance do NOT exceed the GVWR.

**GAWR (Gross Axle Weight Rating)** - is the maximum permissible weight, including cargo, fluids, optional equipment and accessories that can be safely supported by a combination of all axles.

**UVW (Unloaded Vehicle Weight)\*** - is the typical weight of the unit as manufactured at the factory. It includes all weight at the unit's axle(s) and tongue or pin and LP Gas. The UVW does not include cargo, fresh potable water, additional optional equipment or dealer installed accessories.

\*Estimated Average based on standard build optional equipment.

**CCC (Cargo Carrying Capacity)\*\*** - is the amount of weight available for fresh potable water, cargo, additional optional equipment and accessories. CCC is equal to GVWR minus UVW. Available CCC should accommodate fresh potable water (8.3 lbs per gallon). Before filling the fresh water tank, empty the black and gray tanks to provide for more cargo capacity.

\*\* Estimated average based on standard build optional equipment

Each Forest River RV is weighed at the manufacturing facility prior to shipping. A label identifying the unloaded vehicle weight of the actual unit and the cargo carrying capacity is applied to every Forest River RV prior to leaving our facilities.

The load capacity of your unit is designated by weight, not by volume, so you cannot necessarily use all available space when loading your unit.

All information contained in this brochure is believed to be accurate at the time of publication. However, during the model year, it may be necessary to make revisions and Forest River, Inc., reserves the right to make all such changes without notice, including prices, colors, materials, equipment and specifications as well as the addition of new models and the discontinuance of models shown in this brochure. Therefore, please consult with your Forest River dealer and confirm the existence of any materials, design or specifications that are material to your purchase decision.

## THE SALEM FAMILY OF PRODUCTS



**Learn More**  
Scan this barcode using a QR Reader on your smart phone to learn more about Forest River.



A Berkshire Hathaway company.

**Forest River Inc.**  
411 CR 15, Elkhart, IN 46516  
(574) 296-2084  
www.forestriverinc.com  
www.forestriveraccessories.com

YOUR LOCAL HEMISPHERE DEALER