

DYNAMAX 

A DIVISION OF FOREST RIVER

WE'RE PERFORMANCE DRIVEN



*isata*³



Built on the nimble Mercedes Sprinter, the Isata 3 drives small but lives large. 24FW shown above with Pebble Décor and Delta Dust cabinets.

Standard Features & Options

ISATA 3 Chassis

- Mercedes-Benz® Sprinter Chassis; (Diesel) 3.0L V6 188hp and 325 ft.-lbs. of Torque
- 5-Speed Automatic Transmission with Overdrive
- GVWR: 11,030 lbs.
- GCWR: 15,250 lbs.
- 26.4 Gallon Diesel Fuel Tank
- 4.75 Gallon Diesel Exhaust Fluid Tank
- Trailer Hitch (5,000 lbs.) with 7-Way Round Connection
- Upgraded Hellwig® Sway Bar
- Electronic Stability Package
- Single 100-AH 12V Chassis Battery
- Emergency Start Circuit
- 220-Amp Alternator
- Fuel Filter with Water Separator
- Powder-Coated Chassis Construction
- Anodized Aluminum Running Boards
- Front Safety Steel Construction
- 4.18 Rear Axle Ratio
- Daytime Running Lights
- Exterior Mirror Extended (96")
- Front and Rear Tires: LT215/85 R16
- Front Wheels: Single Steel 5.5" x 16"
- Rear Wheels: Dual Steel 5.5" x 16"
- Spare Tire with Carrier Mounted to Frame
- Leatherette Driver and Passenger Seats with Swivel Base
- Color Backup Camera
- Color Side Cameras
- Radio - LCD Touch Screen
- Front Radio Speakers
- 12V and USB Accessory Ports
- Cruise Control
- Wood Grain Cab Accents
- Adjustable Steering Wheel
- Power, Heated Exterior Mirror Controls
- Power Windows and Locks
- 3-Point, Seat-Mounted Seat Belts
- Air Bags - Driver and Passenger
- Carpeted Cab Mats
- Electronically Controlled Dash
- Air Conditioning
- Drink Holders

Construction

- 1-1/2" Aluminum Framed, Laminated Sidewalls
- Gel Coat Fiberglass Skin with Azdel Backing
- Crowned, Fiberglass Roof
- Front Aerodynamic Fiberglass Cap and Front Wing Panels
- R-8 Insulated Sidewalls and Floor; R-11 Insulated Roof
- Dark-Tinted, Frameless Windows
- Rotational Molded, Easy-to-Clean Compartment Boxes
- Electric Slide System
- Option: Two-Point Hydraulic Stabilizing Jacks

Exterior

- Tinted Gel Coat with Vinyl Graphics
- Side-Mounted Armless, Dual Pitch Patio Awning with LED Lighting and Motion-Activated Retraction
- LED Patio Light
- Black-Trimmed, Radius Entry Door with Deadbolt; Frameless Window and Shade
- Lighted Acrylic Grab Handle
- Lighted Power Entry Step
- Exterior TV Mount (Bedroom TV is interchangeable)
- Exterior Speakers
- Locking Aluminum Exterior Storage Doors with Slam Latches
- Front and Rear LED Clearance and Marker Lighting
- Option: Custom Full Body Paint Package with Diamond Shield

Interior

- Leatherette Wrap-Around Booth Dinette with Table
- Beauflor® Premium Vinyl Flooring
- Deluxe Padded Vinyl Ceiling
- LED Flush-Mount Ceiling Lighting
- Coordinating Window Treatments with "Quick Change" Fabric Panels
- Night Roller Shades
- Wood Grain Italian Ultralight Cabinet and Door Construction
- Hidden Hinge Cabinet Door Hardware

- Full Extension, Soft-Closing Drawer Guides
- Easy Access Battery Compartment Beneath Entry Step
- Lighted Entry with Non-Skid Rubber Step and Steel Risers
- Heat Shield Front Privacy Shades
- Video Package - Radio/CD/DVD/Bluetooth with Zoned Speaker Control
- USB Charging Ports
- 28" 12V LED TV with Full-Function Remote (Living Area)

Kitchen

- Refrigerator: 2-Way, Stainless Steel 7.0 cu. ft. Flush-Mount, Double-Door
- 3-Burner (Sealed) Gas Range with Glass Cover
- Convection Microwave Oven
- Solid Surface Countertops
- Solid Surface Backsplash
- Solid Surface Countertop Extension
- Stainless Steel Round Bowl Sink
- Solid Surface Sink Cover
- Residential Single-Handle Faucet with Pullout Sprayer
- MaxxAir® Power Vent with Built-In Rain Cover
- Kitchen Trash Can (Floor Plan Specific)

Bedroom

- Queen Mattress (60" x 74") with iCool® Sleep System (Gel-Infused Memory Foam)
- Designer Bedsprad, Pillow Shams and Pillows
- LED Reading Lights
- Privacy Partition
- 32" 110V LED TV
- USB Charging Ports
- MaxxAir® Power Vent with Built-In Rain Cover
- Nightstand

Bathroom

- ABS Shower
- Shower Skylight
- Glass Shower Door
- Option: Arcadia® Soft Shower Door (Saves 50 lbs. in Carrying Capacity)
- Metal Shower Head with On/Off and Matching Dual Valve Faucet

- Foot-Flush Toilet
- Residential High-Rise Vanity Faucet with Glass Vessel Sink
- MaxxAir® Power Vent with Built-in Rain Cover

Utilities

- Dual 12V Group 31 AGM Auxiliary Batteries
- Battery Disconnect at Entry
- 30-Amp Service
- Onan® 3.6 kW LP Generator with Auto Transfer and Isolator Pads
- Air Conditioner: Roof-Mount 15,000 BTU with Heat Pump
- Furnace: 20,000 BTU Electronic Ignition
- Remote Thermostatically Controlled Heating/Cooling
- Tankless On-Demand Water Heater
- 1,000W Inverter
- Water Purification System (Whole Coach)
- LP Tank: 20.3 gallon (WC)
- LP Quick Connect
- Exterior Service Station - Including Tank Monitor Panel, Drain Valves and Shower
- Interior Monitor Panel with LPG/Tank/Battery Readout
- Exterior GFCI Receptacle
- Jack® Digital Antenna with LED Signal Strength Indicator
- Cable TV/Satellite Hookup
- Backing for Roof-Mounted Satellite Dish
- Converter
- Black Tank Flush
- 12V Tank Heaters: Fresh and Holding Tanks
- 12V High-Capacity, On-Demand Water Pump
- Carbon Monoxide, LP Gas, and Smoke Detectors
- Fire Extinguisher
- Option: Solar Panels - Two 100 Watt and 30 Amp Controller



Key Dimensions:	24FW	24RW
GVWR	11,030 lbs.	11,030 lbs.
GCWR	15,250 lbs.	15,250 lbs.
GAWR - Front	4,080 lbs.	4,080 lbs.
GAWR - Rear	7,720 lbs.	7,720 lbs.
Overall Length	24'7"	24'7"
Exterior Width	94"	94"
Wheelbase	170"	170"
Overall Exterior Height	11' 3"	11' 3"
Interior Height	81"	81"
Fuel Capacity	26.4 Gal.	26.4 Gal.
Water Capacities (Gal.)		
Fresh/Gray/Black	35/32/32	35/32/32
LPG Capacity	20.3 Gal.	20.3 Gal.
Awning Length	16'	16'

Please refer to the back cover for chart definitions.

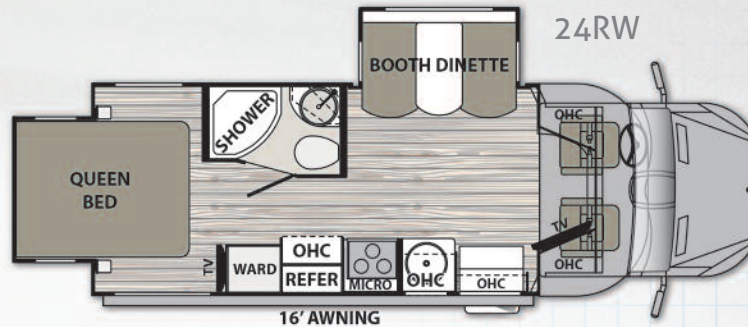
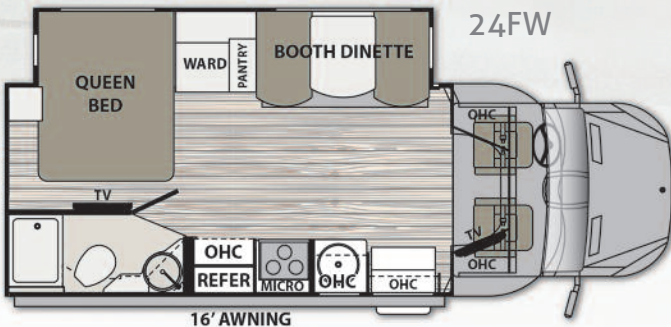



24FW shown with Pebble Décor and Delta Dust Cabinets.

At Dynamax, reaching a higher standard is not an option, it's a tradition.



DYNAMAX
A DIVISION OF FOREST RIVER
WE'RE PERFORMANCE DRIVEN

2745 Northland Dr. ■ Elkhart IN 46514
888-295-7859 ■ www.dynamaxcorp.com

Your Authorized Isata 3 Dealer

GVWR (Gross Vehicle Weight Rating) - is the maximum permissible weight of the unit when fully loaded. It includes all weights, inclusive of all fluids, occupants, cargo, optional equipment and accessories. For safety and product performance do NOT exceed the GVWR.

GCWR (Gross Combined Weight Rating) - is the maximum permissible loaded weight of your motor home and any towed trailer or towed vehicle. Actual GCWR of this vehicle may be limited by the sum of the GVWR and the installed hitch receiver maximum capacity rating; see hitch rating label for detail.

GAWR (Gross Axle Weight Rating) - is the maximum permissible weight, including cargo, fluids, optional equipment and accessories that can be safely supported by each axle.

UVW (Unloaded Vehicle Weight)** - is the typical weight of the unit as manufactured at the factory. It includes all weight at the unit's axle(s), including full fuel, all fluids and LP Gas. The UVW does not include cargo, fresh potable water, additional optional equipment or dealer installed accessories.

CCC (Cargo Carrying Capacity)** - is the amount of weight available for fresh potable water, cargo, passengers, additional optional equipment and accessories. CCC is equal to GVWR minus UVW. Available CCC should accommodate fresh potable water (8.3 lbs. per gallon). Before filling the fresh water tank, empty the black and gray tanks to provide for more cargo capacity.

*Estimated Average based on standard build optional equipment. **Estimated average based on standard build optional equipment.

Each Forest River RV is weighed at the manufacturing facility prior to shipping. A label identifying the unloaded vehicle weight of the actual unit and the cargo carrying capacity is applied to every Forest River RV prior to leaving our facilities.

The load capacity of your unit is designated by weight, not by volume, so you cannot necessarily use all available space when loading your unit.

Actual towing capacity is dependent upon your particular loading and towing circumstances, which includes the GVWR, GAWR and GCWR as well as adequate trailer brakes. Please refer to the Operator's Manual of your vehicle for further towing information.

All information contained in this brochure is believed to be accurate at the time of publication. However, during the model year, it may be necessary to make revisions and Forest River, Inc., reserves the right to make all such changes without notice, including prices, colors, materials, equipment and specifications as well as the addition of new models and the discontinuance of models shown in this brochure. Therefore, please consult with your Forest River dealer and confirm the existence of any materials, design or specifications that are material to your purchase decision. 11/15 ©2015 Dynamax



PRE-DELIVERY INSPECTION FACILITY

20,000 square feet of quality assurance. The bare essentials for a premium product. This state-of-the-art facility gives immediate daily feedback to production for quality assurance in every unit built.



Forest River, Inc. encourages our customers to purchase their Forest River products from a local dealership whenever possible for the following reasons:

- 1) Forest River, Inc. dealers are independently owned and operated businesses so priority service and scheduling is at their discretion and is often provided to customers that purchased their unit at that dealership.
- 2) Purchasing locally allows customers to establish meaningful relationships with a dealer, enhancing the RV experience through assistance with product questions, user tips or RV regulations for your state or country, and much more!
- 3) Canadian customers must meet requirements to bring an RV purchased out of the country to their home. These requirements may involve additional inspections and certifications, taxes and fees. Your local Canadian Dealer is a professional at meeting these requirements.
- 4) Scheduling timely warranty repairs and adjustments through a local dealership provides far greater flexibility and convenience to you, the customer!

It is the goal of Forest River, Inc. that all of our RV owners fully enjoy the RV experience and that customer satisfaction meets or exceeds their expectations!

24/7 EMERGENCY ROADSIDE ASSISTANCE

For a worry-free ownership experience Forest River includes one year of Coach-Net RV Technical & Roadside Assistance with each RV purchase. Whether new to the RV lifestyle or an experienced RV enthusiast, Forest River owners have 24/7 access to technical, operational and emergency road service coverage throughout the US & Canada. Coach-Net's fast, dependable service is just a phone call away.

Coach-Net®
RV Technical & Roadside Assistance

FREE MEMBERSHIP
to Forest River Owners' Group

www.forestriverfrog.com



Learn More
Scan this barcode using a QR Reader on your smart phone to learn more about Forest River.



A Berkshire Hathaway company.