

CONCORD
by Coachmen

CONCORD

by Coachmen



Coachmen
Leader to the Great Outdoors.

CONCORD FEATURES AND SPECIFICATIONS



visit
CoachmenRV.com/Concord
 for more photos, virtual tours, training videos and the latest model standards and options.

300DS SHOWN WITH ARCTIC DÉCOR

TOP FEATURES

- **Azdel with 100% Aluminum Framing with Curved Sidewall Construction**
Longer lasting coach, higher "r" values than competition, formaldehyde free and more
- **Even Cool™ A/C**
Residential duct work system that will be quieter, more efficient and consistent in cooling the entire coach
- **Solid Surface Countertops**
- **Molded Fiberglass Front and Rear Cap**
Gives the coach a sleek modern look while also providing a thicker protection to the coach
- **Integrated Motorized Step**
Maximize ground clearance while giving ease to all who enter and exit the coach

CONCORD SPECIFICATIONS

| MODEL | 300TS | 300DS |
|------------------------------|--------------------------|--------------------------|
| Chassis | 4500-CHEVY/ E450 FORD | 4500-CHEVY/ E450 FORD |
| Engine | V8-6.0L/V10-6.8L | V8-6.0L/V10-6.8L |
| Horse Power | 324/305 | 324/305 |
| Torque | 373/420 | 373/420 |
| Wheel Base | 209"/208" | 224"/223" |
| GVWR (lbs.) | 14,200/12,500 | 14,200/12,500 |
| GCWR (lbs.) | 20,000/22,000 | 20,000/22,000 |
| UVW (approx. lbs.) | 12,120/12,380 | 11,875/11,955 |
| CCC (approx. lbs.) | 2,080/2,120 | 2,325/2,505 |
| GAWR Front (lbs.) | 4,600/5,000 | 4,600/5,000 |
| GAWR Rear (lbs.) | 9,600/9,600 | 9,600/9,600 |
| Interior Height | 6' 6" | 6' 6" |
| Exterior Width | 7' 10" | 7' 10" |
| Exterior Height (with A/C) | 10' 3" | 10' 3" |
| Exterior Length (with Hitch) | 31' 6"/31' 0" | 33' 3"/32' 9" |
| Hitch Weight (lbs.) | 5,000/7,500 | 5,000/7,500 |
| Fuel Capacity (gal.) | 57/55 | 57/55 |
| LP Capacity (lbs.) | 85 | 85 |
| Fresh Water Capacity (gal.) | 41 | 41 |
| Water Heater Capacity (gal.) | 6 | 6 |
| Grey Tank Capacity (gal.) | 52 | 52 |
| Black Tank Capacity (gal.) | 28 | 28 |
| Exterior Storage (cu. ft.) | 36 | 43 |
| Awning Length | 20' | 19' |

GVWR (Gross Vehicle Weight Rating) is the maximum permissible weight of the unit when fully loaded. It includes all weights, inclusive of all fluids, occupants, cargo, optional equipment and accessories. For safety and product performance do NOT exceed the GVWR.

GCWR (Gross Combined Weight Rating) is the maximum permissible loaded weight of your motor home and any towed trailer or towed vehicle. Actual GCWR of this vehicle may be limited by the sum of the GVWR and the installed hitch receiver maximum capacity rating; see hitch rating label for detail.

GAWR (Gross Axle Weight Rating) is the maximum permissible weight, including cargo, fluids, optional equipment and accessories that can be safely supported by each axle.

UVW (Unloaded Vehicle Weight)* is the typical weight of the unit as manufactured at the factory. It includes all weight at the unit's axle(s), including full fuel, all fluids and LP Gas. The UVW does not include cargo, fresh potable water, additional optional equipment or dealer installed accessories.

*Estimated Average based on standard build optional equipment.

CCC (Cargo Carrying Capacity)** is the amount of weight available for fresh potable water, cargo, passengers, additional optional equipment and accessories. CCC is equal to GVWR minus UVW. Available CCC should accommodate fresh potable water (8.3 lbs per gallon). Before filling the fresh water tank, empty the black and gray tanks to provide for more cargo capacity.

** Estimated average based on standard build optional equipment

Each Coachmen motorhome is weighed at the manufacturing facility prior to shipping. A label identifying the unloaded vehicle weight of the actual unit and the cargo carrying capacity is applied to every Coachmen motorhome prior to leaving our facilities.

The load capacity of your unit is designated by weight, not by volume, so you cannot necessarily use all available space when loading your unit.

Actual towing capacity is dependent upon your particular loading and towing circumstances, which includes the GVWR, GAWR and GCWR as well as adequate trailer brakes. Please refer to the Operator's Manual of your vehicle for further towing information.



300TS SHOWN WITH ARCTIC DÉCOR

CONCORD FLOORPLANS AND OPTIONS

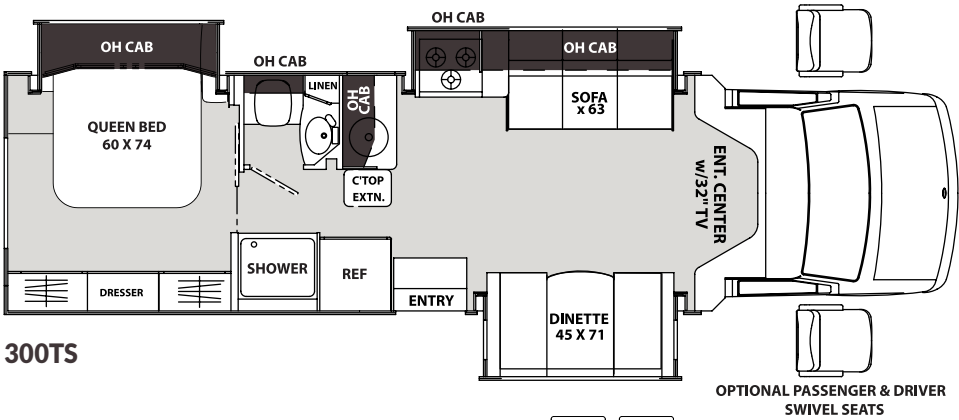

300TS

OPTIONAL PASSENGER & DRIVER SWIVEL SEATS

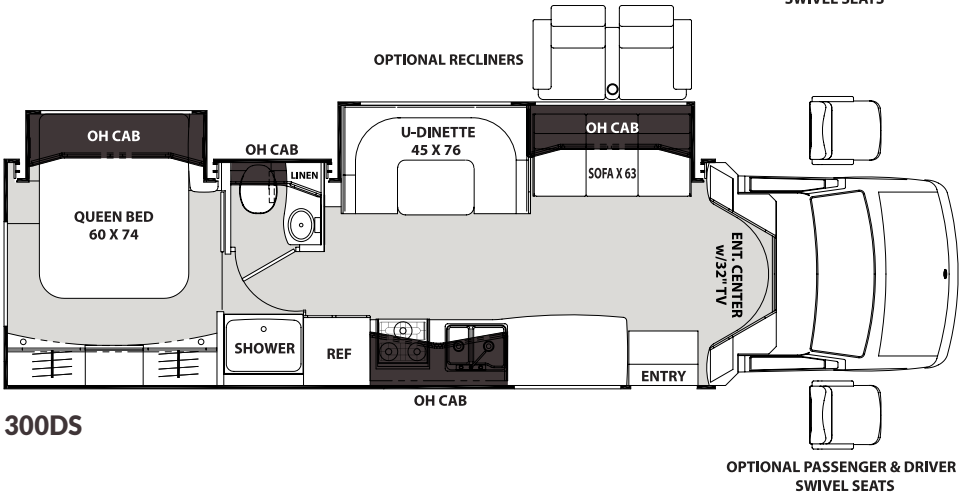

300DS

OPTIONAL PASSENGER & DRIVER SWIVEL SEATS



300DS SHOWN WITH WINDSOR DÉCOR



300DS SHOWN WITH ARCTIC DÉCOR



300DS SHOWN WITH ARCTIC DÉCOR



300DS SHOWN

CONCORD FULL BODY PAINT OPTIONS



WINE CELLAR

ELECTRIC BLUE

VINTAGE BLACK



300TS SHOWN WITH ARCTIC DÉCOR



300DS SHOWN WITH WINDSOR DÉCOR

visit
**CoachmenRV.com/
 Concord**
 for more photos, virtual
 tours, training videos and the
 latest model standards
 and options.

YOUR **CONCORD** DEALER



Coachmen Owner "Digital Kit" App

Now you can have your Owner's Manual with you wherever you are. Download our FREE App from the App Store or Google Play and you'll have the information right at your fingertips.



www.ForestRiverBuyLocal.com



Learn More
 Scan this barcode using
 a QR Reader on your
 smart phone to learn
 more about Forest River.



A Berkshire Hathaway company.

All information contained in this brochure is believed to be accurate at the time of publication. However, during the model year, it may be necessary to make revisions and Coachmen reserves the right to make all such changes without notice, including prices, colors, materials, equipment and specifications as well as the addition of new models and the discontinuance of models shown in this brochure. Therefore, please consult with your Coachmen dealer and confirm the existence of any materials, design or specifications that are material to your purchase decision. 1/19

©Copyright 2019 Coachmen RV a Division of Forest River Inc - All Rights Reserved.



**24/7 EMERGENCY
 ROADSIDE ASSISTANCE
 WITH VEHICLE PURCHASE***

- | | |
|----------------|-----------------|
| TOWING | WINCH-OUT |
| JUMP-STARTS | MOBILE MECHANIC |
| TIRE CHANGES | TECHNICAL |
| FLUID DELIVERY | SUPPORT |
| LOCKOUT | DEALER LOCATOR |
| SERVICE | SERVICES |



*VALID FOR 1 YEAR FROM DATE OF PURCHASE



COACHMEN OWNERS ASSOCIATION

FREE MEMBERSHIP
www.coachmenowners.com



423 N. Main Street • P.O. Box 30
 Middlebury, IN 46540

To learn more about Coachmen RV and our products and see how Coachmen is making the easy life easier, call us toll free at **(800) 353-7383**, or visit www.coachmenrv.com