



FR3

BY FOREST RIVER

Cross Over Motorhome

Specifications

30DS 32DS 33DS

GVWR (Gross Vehicle Weight Rating) is the maximum permissible weight of the unit when fully loaded. It includes all weights, inclusive of all fluids, occupants, cargo, optional equipment and accessories. For safety and product performance do NOT exceed the GVWR.

GCWR (Gross Combined Weight Rating) is the maximum permissible loaded weight of your motor home and any towed trailer or towed vehicle. Actual GCWR of this vehicle may be limited by the sum of the GVWR and the installed hitch receiver maximum capacity rating; see hitch rating label for detail.

GAWR (Gross Axle Weight Rating) is the maximum permissible weight, including cargo, fluids, optional equipment and accessories that can be safely supported by each axle.

UVW (Unloaded Vehicle Weight)* is the typical weight of the unit as manufactured at the factory. It includes all weight at the unit's axle(s), including full fuel, all fluids and LP Gas. The UVW does not include cargo, fresh potable water, additional optional equipment or dealer installed accessories.

*Estimated Average based on standard build optional equipment.

CCC (Cargo Carrying Capacity)** is the amount of weight available for fresh potable water, cargo, passengers, additional optional equipment and accessories. CCC is equal to GVWR minus UVW. Available CCC should accommodate fresh potable water (8.3 lbs per gallon). Before filling the fresh water tank, empty the black and gray tanks to provide for more cargo capacity.

** Estimated average based on standard build optional equipment.

Each Forest River RV is weighed at the manufacturing facility prior to shipping. A label identifying the unloaded vehicle weight of the actual unit and the cargo carrying capacity is applied to every Forest River RV prior to leaving our facilities.

The load capacity of your unit is designated by weight, not by volume, so you cannot necessarily use all available space when loading your unit.

Actual towing capacity is dependent upon your particular loading and towing circumstances, which includes the GVWR, GAWR and GCWR as well as adequate trailer brakes. Please refer to the Operator's Manual of your vehicle for further towing information.

	30DS	32DS	33DS
Chassis	Ford	Ford	Ford
Engine	V-10	V-10	V-10
Horsepower	320 HP	320 HP	320 HP
Torque	460 ft-lbs	460 ft-lbs	460 ft-lbs
Wheelbase	190"	228"	228"
Fuel Capacity	80 gal	80 gal	80 gal
Tire Size	245/70R19.5	245/70R19.5	245/70R19.5
GVWR	18,000 lbs	20,500 lbs	20,500 lbs
GCWR	23,000 lbs	26,000 lbs	26,000 lbs
CCC	2,530 lbs	1,978 lbs	1,978 lbs
GAWR Front	7,000 lbs	7,500 lbs	7,500 lbs
GAWR Rear	12,000 lbs	13,500 lbs	13,500 lbs
Exterior Storage	112 cu ft	116 cu ft	155 cu ft
Safety Belts	8	8	6
LP Tank	24.5 gal	24.5 gal	24.5 gal
Water Heater	6 gal	6 gal	6 gal
Furnace	35,000 BTU	35,000 BTU	35,000 BTU
Fresh Water	50 gal	50 gal	50 gal
Grey Tank	42 gal	42 gal	42 gal
Black Tank	42 gal	42 gal	42 gal
Length	31' 8"	33' 11"	34' 10"
Exterior Width	99.5"	99.5"	99.5"
Exterior Height w/ A/C	12' 3"	12' 5"	12' 5"
Interior Width	95.5"	95.5"	95.5"
Interior Height	82"	82"	82"
Awning Length	16'	12'	19'

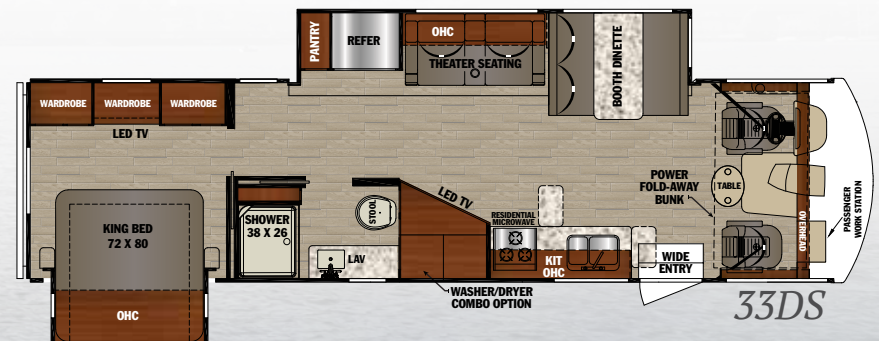
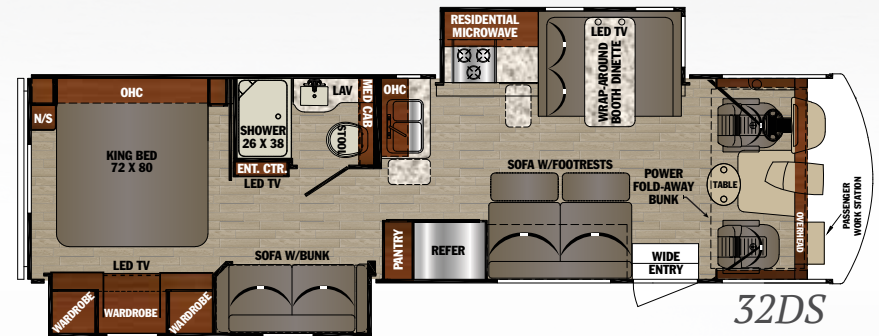
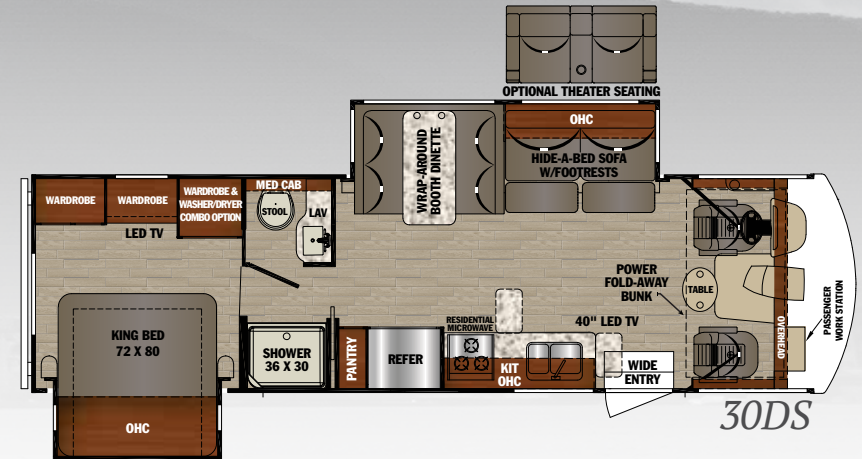

FEATURES, STANDARDS & OPTIONS

Construction & Exterior

White Diamond Pearl Gel-Coat Sidewalls w/Graphics
 One Piece Fiberglass Roof
 Fiberglass Front Cap
 Bi Hi/Lo Headlights
 LED Turn Signals
 Side-swing Front Grill w/Mesh Bug Shield
 Lower Fog Lights w/ LED Accents
 Color Side and Rear Camera Package
 "SUPER STORAGE" Pass-through Rear Cargo Compartment
 Grey Rotocast Storage Boxes w/Drains
 Rear Roof Ladder
 Power Patio Awning w/LED Light
 Slideout Room Awnings
 Rubber Tread Entry Steps
 Outside Shower
 Electric Entrance Step
 Rubberized Entry Assist Handle
 Vacuum Bonded Construction
 Steel Front Cockpit Cage
 Hydraulic 4-Point Leveling Jacks
 Outside Entertainment Center w/TV and Marine-Grade Speakers
 Quick Connect Exterior LP Fitting
 Solar Prep

Chassis & Cockpit

Molded ABS Automotive Dash w/Laptop Console and 110V Outlet
 Power Front Sun Shade
 Ultra Leather Driver/Passenger Seating w/Double Stitching
 Low Profile Cockpit Engine Cover
 Pioneer Dash Entertainment System w/AM/FM/CD/DVD/Bluetooth/Backup Color Monitor/USB and Sound Selector (Mirror Link Navigation Available with Most Smart Phones)
 5,000 lb. Tow Hitch w/7-Way Plug
 Automotive Style Bonded One Piece Windshield w/Backlit Logo
 Power Heated Exterior Mirrors
 Driver/Passenger LED Map Lights
 Diamond Plate Rubber Floor Covering

Interior

Entry Assist Handle
 Power Front Fold-Away Overhead Bunk w/Ladder

40" LED TV
 KING Jack™ Digital TV Antenna w/Built-in Signal Meter
 Radius Interior Ceiling
 Shaw Residential Vinyl Flooring
 Brushed Nickel Hardware
 Ultra Leather Sofa w/Dual Footrests (Hide-a-Bed 30DS, Jack Knife 32DS)
 Ultra Leather Wrap Around Dinette Booth w/Comfort Cushions
 Heavy Duty Full Extension Drawer Guides
 Night Shade Window Treatments
 LED Lighting Throughout
 Theatre Seating (33DS only)

Galley

Four Door 12 cu. ft. Gas/Electric Refrigerator
 3-Burner Cooktop w/ Oven and Flush Mount Stove Cover
 Flip-up and Pullout Countertop Extensions
 Residential OTR Microwave Oven
 Large Double Bowl Stainless Steel Sink and Pullout Faucet
 Custom Countertops
 Trash Can Storage Area Below Sink
 12 Volt Charging Station
 Residential Kitchen Backsplash Tile

Bedroom & Bathroom

72" x 80" Residential King Bed
 Bedroom Wardrobe
 Night Stands w/Charging Stations
 Toilet with Foot Flush
 Stainless Steel Lavatory Sink and Fixture
 Brushed Nickel Framed Glass Shower
 Washer Dryer Combo Prep (N/A 32DS)

Safety & Convenience

Extra Wide Entry Door w/Deadbolt Lock
 Forest River Command Center
 Carbon Monoxide and LP Detectors
 Smoke Alarm
 Fire Extinguisher

Electrical & Plumbing

5.5 KW Onan Generator
 (2) High Output Quiet Air Command™ Ducted Roof A/C w/Chill Construction and Heat Pump (Front A/C only)
 (2) Deep Cycle House Batteries
 Battery Disconnect Switch
 Emergency Start Switch
 6 Gallon Gas/Electric Water Heater

Arctic Pack System (Heated Holding Tanks)
 Black Tank Flush
 35,000 BTU Furnace
 50 Amp Service
 Progressive Dynamics Converter
 USB Charging Stations

Decor

Oakley Seal
 Pebble

Cabinetry

Landis Ash and Black Walnut Raised Panel Wood

Options

Theatre Seating (in place of Hide-a-Bed on 30DS, Standard on 33DS)
 Combo Washer/Dryer (30DS, 33DS)



For more information visit
www.forestriverinc.com/fr3

Forest River, Inc.
 FR3 Division
 902 County Road 1
 Elkhart, IN 46515
 (574) 367.3285



YOUR FR3 DEALER

CUSTOMER SATISFACTION



www.ForestRiverBuyLocal.com

FREE MEMBERSHIP
 to Forest River Owners' Group

www.forestriverfrog.com



For more information on the Ford F53 chassis, scan here.



24/7 EMERGENCY ROADSIDE ASSISTANCE

For a worry-free ownership experience Forest River includes one year of Coach-Net RV Technical & Roadside Assistance with each RV purchase. Whether new to the RV lifestyle or an experienced RV enthusiast, Forest River owners have 24/7 access to technical, operational and emergency road service coverage throughout the US & Canada. Coach-Net's fast, dependable service is just a phone call away.

Coach-Net®

RV Technical & Roadside Assistance

For more information on Coach-Net, scan here.



Learn More
 Scan this barcode using a QR Reader on your smart phone to learn more about Forest River.



A Berkshire Hathaway company.

All information contained in this brochure is believed to be accurate at the time of publication. However, during the model year, it may be necessary to make revisions and Forest River, Inc., reserves the right to make all such changes without notice, including prices, colors, materials, equipment and specifications as well as the addition of new models and the discontinuance of models shown in this brochure. Therefore, please consult with your Forest River, Inc., dealer and confirm the existence of any materials, design or specifications that are material to your purchase decision. 11/18

©2018 FR3
 a Division of Forest River, Inc., a Berkshire Hathaway company. All Rights Reserved.