

# Sunseeker

BY FOREST RIVER

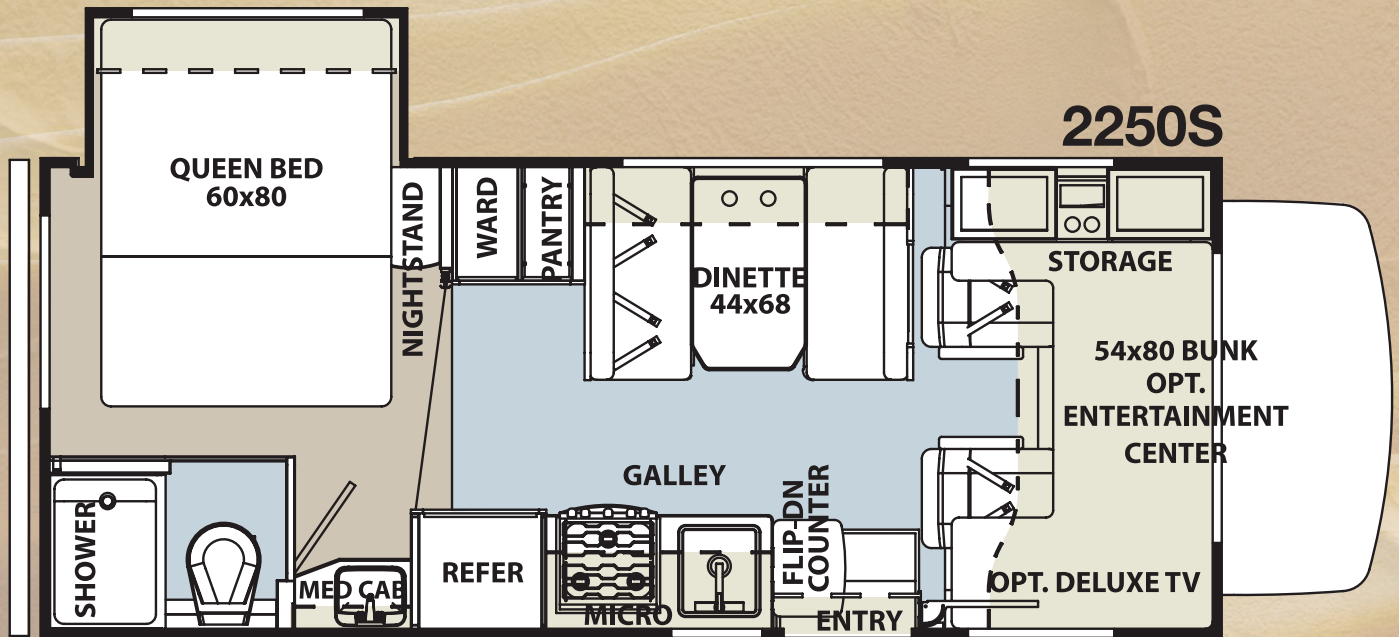

CHASSIS	FORD	CHEVY	DIMENSIONS AND CAPACITIES	
MODEL	2250S	2250S	EXTERIOR HEIGHT W/ A/C	11'-3"
WHEELBASE	158"	159"	EXTERIOR WIDTH	101"
GVWR	12500	14200	INTERIOR WIDTH	95.5"
UVW	9660	9580	INTERIOR HEIGHT FRT/REAR	84"/ 77"
GCWR	18500	20000	FRESH WATER w/HEATER (GAL)	41
NCC	2840	4620	GREY WATER (GAL)	32
FUEL CAP.(GAL)	55	57	BLACK WATER (GAL)	27
HITCH RATING	5k/500	5k/500	L.P. CAPACITY (GAL)	9.8
TOTAL LENGTH	23'-10"	24'-4"	AWNING LENGTH	14'
			EXTERIOR STORAGE (CU. FT.)	32
			WATER HEATER (GAL)	6

## DECOR OPTIONS



STONE



KHAKI



BAMBOO



SHAKER CHERRY

## STANDARDS AND OPTIONS

### Warranty:

#### Standard Features

- 12 Months/ 12,000 miles basic limited warranty
- Bumper-to-Bumper 3 years / 36,000 mile limited chassis warranty
- 5 years/ 60,000 mile limited powertrain warranty (Ford)
- 5 years/100,000 limited powertrain warranty (Chevy)

### Systems:

#### Standard Features

- Battery disconnect
- Water heater bypass kit
- Deep cycle coach battery
- 30 amp, 12 volt distribution panel & 30' power cord
- 55 amp, 12 volt power converter
- Six gallon gas/electric electronic ignition DSI water heater
- 30,000 BTU electronic ignition furnace
- Emergency start switch
- Cable TV jack
- 13.5 K BTU ducted roof air conditioner
- 4.0 KW Onan Microquiet generator
- One year CoachNet service

### Exterior:

#### Standard Features

- 2" laminated Gel Coat sidewalls, vacuum bonded with aluminum frame structure, steel backers & block foam insulation
- A & E power awning
- Fiberglass roof
- Wheel liners
- Lockable Rotocast storage compartments
- Patio Light
- Entry door with screen door & dead bolt door lock
- All radius style exterior doors
- Entry assist handle
- 110 volt, GFI protected exterior receptacle
- Tinted sliding windows
- Deluxe break-away mirrors
- 5,000 lb. tow hitch with 7-pin connector
- Integrated entry step
- "Easy-Access" battery compartment in entry step

### Cab Area:

- 7" touch screen AM/FM radio w/ CD, DVD, USB and Bluetooth
- Cab area privacy curtains
- Dual 12 volt power points
- Cruise control
- Power windows and door locks
- Keyless entry (Ford chassis only)

### Galley Area:

- High-neck faucet
- Three burner range with oven
- 6 cubic foot refrigerator/freezer
- Range hood with fan and light
- Residential-style drawer construction
- Microwave oven
- Flip-up countertop extension

### Bathroom Area:

- Large medicine cabinet with mirrored cabinet doors
- Deep sink with dual control faucet
- Porcelain toilet
- Frosted glass shower door
- Bath amenity package (towel bar, tissue, toothbrush & soap holder)
- Electric roof vent fan
- Wall mount mirror
- Molded ABS shower pan & surround
- Shower head with flexible hose extension
- Shower skylight

### Bedroom Area:

- 60" x 80" Queen mattress
- Pleated night shades
- Bi-fold privacy door

### Living Room Area:

- Shaker cherry cabinetry
- Rubbed bronze handles
- Pleated night shades
- 7 foot ceiling height
- Convenience center

### Optional Features:

- Cab over entertainment center with 42" TV
- 32" flat panel TV w/ DVD
- Aluminum running boards
- Back-up camera with monitor
- Fiberglass front cap

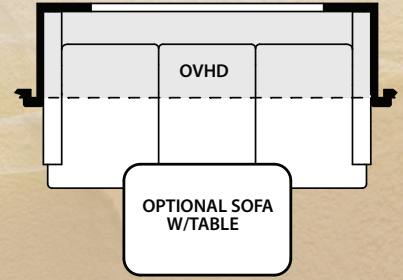

SOFA OPTION

Composite Sidewalls Made From...



**SuperLite**  
Greener By Design™

SuperLite® is a registered trademark of AZDEL, Inc.



### PRE-DELIVERY INSPECTION FACILITY

20,000 square feet of quality assurance. The bare essentials for a premium product. This state-of-the-art facility gives immediate daily feedback to production for quality assurance in every unit built.



Forest River, Inc. encourages our customers to purchase their Forest River products from a local dealership whenever possible for the following reasons:

- 1) Forest River, Inc. dealers are independently owned and operated businesses so priority service and scheduling is at their discretion and is often provided to customers that purchased their unit at that dealership.
- 2) Purchasing locally allows customers to establish meaningful relationships with a dealer, enhancing the RV experience through assistance with product questions, user tips or RV regulations for your state or country, and much more!
- 3) Canadian customers must meet requirements to bring an RV purchased out of the country to their home. These requirements may involve additional inspections and certifications, taxes and fees. Your Local Canadian Dealer is a professional at meeting these requirements.
- 4) Scheduling timely warranty repairs and adjustments through a local dealership provides far greater flexibility and convenience to you, the customer!

It is the goal of Forest River, Inc. that all of our RV owners fully enjoy the RV experience and that customer satisfaction meets or exceeds their expectations!



#### Learn More

Scan this barcode using a QR Reader on your smart phone to learn more about Forest River.



A Berkshire Hathaway company.

914 CR 1 ELKHART, IN 46514 574.262.2212 800.445.2825  
www.forestriverinc.com/sunseeker

All specifications contained herein are based on the latest product information at time of printing. Forest River reserves the right to make changes in colors, materials, equipment and specifications at any time without notice and assumes no responsibility for any errors in this brochure.

YOUR SUNSEEKER DEALER

©2014 Sunseeker - a division of Forest River Inc.  
A Berkshire Hathaway company